

\$399,900 - 132 Richfield Road, Edmonton

MLS® #E4432152

\$399,900

3 Bedroom, 2.50 Bathroom, 1,199 sqft
Single Family on 0.00 Acres

Richfield, Edmonton, AB

This property could be a great purchase for the right buyer. Although it requires updating, as it is mostly in original condition , yet is located on large, 7,148 sq.ft (664.06 sq.m.) lot backing walking path with steps to Bhullar Park. Fantastic, double detached, oversized (23.3' by 23.3' interior) garage was built with permit in 2002. Main floor offers living room with wood burning fire place, kitchen, 3 bedrooms and 1 and a half baths. Basement is fully developed and has large windows. Located close to schools, transportation and good proximity to Whitemud Drive and Anthony Henday highway. Property is being sold in "as-is" condition. Make a move and build some sweat equity!



Built in 1973

Essential Information

| | |
|----------------|-----------|
| MLS® # | E4432152 |
| Price | \$399,900 |
| Bedrooms | 3 |
| Bathrooms | 2.50 |
| Full Baths | 2 |
| Half Baths | 1 |
| Square Footage | 1,199 |
| Acres | 0.00 |
| Year Built | 1973 |

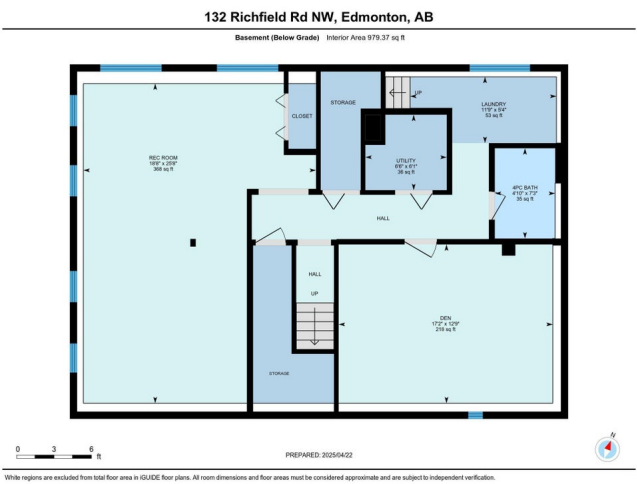

| | |
|----------|------------------------|
| Type | Single Family |
| Sub-Type | Detached Single Family |
| Style | Bi-Level |
| Status | Active |

Community Information

| | |
|-------------|--------------------|
| Address | 132 Richfield Road |
| Area | Edmonton |
| Subdivision | Richfield |
| City | Edmonton |
| County | ALBERTA |
| Province | AB |
| Postal Code | T6K 0A2 |

Amenities

| | |
|-----------|------------------------------------|
| Amenities | See Remarks |
| Parking | Double Garage Detached, Over Sized |

Interior

| | |
|-------------------|--|
| Interior Features | ensuite bathroom |
| Appliances | Dryer, Garage Opener, Refrigerator, Stove-Electric, Washer |
| Heating | Forced Air-1, Natural Gas |
| Stories | 2 |
| Has Basement | Yes |
| Basement | Full, Finished |

Exterior

| | |
|-------------------|---|
| Exterior | Wood, Stucco |
| Exterior Features | Flat Site, Landscaped, Schools, Shopping Nearby |
| Roof | Asphalt Shingles |
| Construction | Wood, Stucco |
| Foundation | Concrete Perimeter |

Additional Information

| | |
|----------------|------------------|
| Date Listed | April 23rd, 2025 |
| Days on Market | 3 |
| Zoning | Zone 29 |

DATA IS DEEMED RELIABLE BUT IS NOT GUARANTEED ACCURATE BY THE REALTORS® ASSOCIATION OF EDMONTON. COPYRIGHT 2025 BY THE REALTORS® ASSOCIATION OF EDMONTON. ALL RIGHTS RESERVED. Trademarks are owned or controlled by the Canadian Real Estate Association (CREA) and identify real

estate professionals who are members of CREA (REALTOR®®, REALTORS®®) and/or the quality of services they provide (MLS®®, Multiple Listing Service®®)

Listing information last updated on April 26th, 2025 at 7:47pm MDT