

\$250,000 - 14 10 Cranberry Drive, Sherwood Park

MLS® #E4435549

\$250,000

2 Bedroom, 2.50 Bathroom, 1,298 sqft
Condo / Townhouse on 0.00 Acres

Davidson Creek, Sherwood Park, AB

Roll up your sleeves and start building equity with this bright end-unit townhouse! Enjoy the convenience of two parking stalls right outside your door, plus visitor parking. Features include a spacious eat-in kitchen, large living room with cozy corner fireplace, and a generous deck for outdoor living. Upstairs you'll find two bedrooms; the primary suite with a large ensuite & both offer walk in closets. A large pantry/closet on the main floor offers potential for relocating laundry from the basement, or keep it as is and suit to your needs. The basement includes a sizable storage/mechanical area with a newer hot water tank, no Poly-B plumbing, and laundry. Great news! Pets are allowed with board approval. Kids can walk to Lakeland Ridge K-9 public school, play at the park or kick the soccer ball around after class and still make it home for dinner – an ideal location for families! Near bus routes and walking distance to grocery stores and other amenities making it suitable for investors as well.

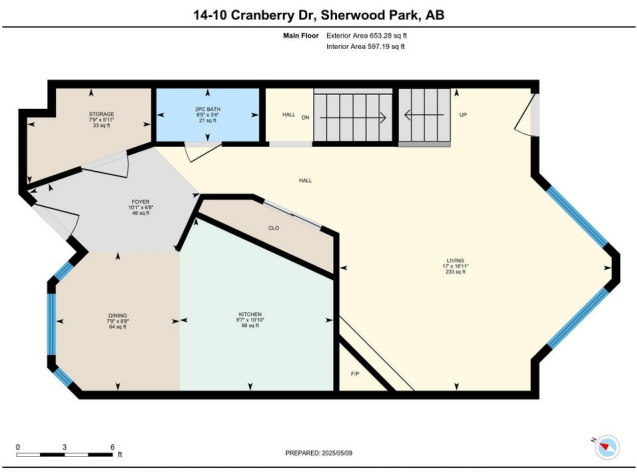

Built in 1997

Essential Information

MLS® #	E4435549
Price	\$250,000
Bedrooms	2

Bathrooms	2.50
Full Baths	2
Half Baths	1
Square Footage	1,298
Acres	0.00
Year Built	1997
Type	Condo / Townhouse
Sub-Type	Townhouse
Style	2 Storey
Status	Active

Community Information

Address	14 10 Cranberry Drive
Area	Sherwood Park
Subdivision	Davidson Creek
City	Sherwood Park
County	ALBERTA
Province	AB
Postal Code	T8H 2A1

Amenities

Amenities	Exterior Walls- 2"x6", Parking-Visitor, Vinyl Windows
Parking Spaces	2
Parking	2 Outdoor Stalls

Interior

Interior Features	ensuite bathroom
Appliances	Dishwasher-Built-In, Dryer, Hood Fan, Oven-Microwave, Refrigerator, Stove-Electric, Vacuum System Attachments, Vacuum Systems, Washer, Window Coverings, See Remarks
Heating	Forced Air-1, Natural Gas
Fireplace	Yes
Fireplaces	Corner, Tile Surround
Stories	3
Has Basement	Yes
Basement	Full, Partially Finished

Exterior

Exterior	Wood, Vinyl
----------	-------------

Exterior Features	Landscaped, No Through Road, Playground Nearby, Public Transportation, Schools, Shopping Nearby
Roof	Asphalt Shingles
Construction	Wood, Vinyl
Foundation	Concrete Perimeter

School Information

Elementary	Lakeland Ridge
Middle	Lakeland Ridge
High	Salisbury Composite High

Additional Information

Date Listed	May 9th, 2025
Days on Market	6
Zoning	Zone 25
Condo Fee	\$323

DATA IS DEEMED RELIABLE BUT IS NOT GUARANTEED ACCURATE BY THE REALTORS® ASSOCIATION OF EDMONTON. COPYRIGHT 2025 BY THE REALTORS® ASSOCIATION OF EDMONTON. ALL RIGHTS RESERVED. Trademarks are owned or controlled by the Canadian Real Estate Association (CREA) and identify real estate professionals who are members of CREA (REALTOR®, REALTORS®) and/or the quality of services they provide (MLS®, Multiple Listing Service®)

Listing information last updated on May 14th, 2025 at 10:32pm MDT